

VASCULAR PLANT CHECKSHEET

Location: P7 757 GSH1006
 Observer: JP, CS, NH

Date: June 1, 2011
 Job Number:

DICOT HERBS												MONOCOT HERBS										
1	2	3	4	5	6	1	2	3	4	5	6	1	2	3	4	5	6					
Achillea millefolium						Erigeron annuus						Plantago lanceolata					Alisma plantago-aquatica					
Actaea pachypoda	X					Erigeron philadelphicus						Plantago major					Allium tricoccum					
Actaea rubra						Erigeron strigosus						Plantago rugelii					Allium					
Agalinus						Erysimum chieranthoides						Podophyllum peltatum					Arisaema triphyllum	X				
Agrimonia gryposepala						Eupatorium maculatum						Polygonum					Asparagus officinalis					
Alliaria petiolaris	X					Eupatorium perfoliatum						Polygonum					Calla palustris					
Amaranthus retroflexus						Eupatorium rugosum						Polygonum					Clintonia borealis					
Ambrosia artemisiifolia						Euphorbia						Polygonum lapathifolium					Convallaria majus					
Amphicarpaea bracteata						Euthamia graminifolia						Polygonum persicaria					Cypripedium calceolus					
Anaphalis margaritacea						Fragaria virginiana	X					Potentilla					Elodea canadensis					
Anemone						Fragaria vesca						Potentilla norvegica					Epipactis helleborine					
Anemone canadensis						Galeopsis tetrahit						Potentilla recta					Erythronium americanum					
Anemone virginiana						Galium						Prenanthes alba					Hemerocallis fulva					
Antennaria neglecta						Galium						Prunella vulgaris					Iris versicolor					
Apocynum androsaemifolium						Galium palustre						Pyrola elliptica					Lemna minor					
Apocynum cannabinum						Galium triflorum						Ranunculus					Lemna trisulca					
Aquilegia canadensis						Geranium maculatum						Ranunculus abortivus					Lilium					
Aralia nudicaulis						Geranium robertianum	X					Ranunculus acris					Maianthemum canadense	X				
Arctium minus						Geum aleppicum	X					Rudbeckia hirta					Maianthemum racemosa	X				
Artemisia						Geum canadense						Rumex acetosella					Maianthemum stellata					
Asarum canadense	X					Geum						Rumex crispus		X			Platanthera					
Asclepias incarnata						Glechoma hederacea						Rumex					Portulacaria cordata					
Asclepias syriaca						Hepatica acutiloba						Sanguinaria canadensis					Polygonatum pubescens					
Aster	X					Hesperis matronalis						Sanicula marilandica					Potamogeton crispus					
Aster cordifolius						Hieracium aurantiacum						Saponaria officinalis					Potamogeton pectinatus					
Aster ericoides						Hieracium caespitosum						Satureja vulgaris					Potamogeton					
Aster lanceolatus						Hieracium						Scutellaria galericulata					Potamogeton					
Aster lateriflorus						Hydrophyllum virginianum						Silene vulgaris					Potamogeton					
Aster macrophyllus						Hypericum perforatum						Sium suave					Sagittaria latifolia					
Aster novae-angliae						Impatiens capensis	X					Solanum dulcamara					Sisyrinchium montanum					
Aster puniceus						Inula helenium						Solidago			X		Smilax herbacea					
Barbarea vulgaris						Lactuca						Solidago altissima					Spiranthes cernua					
Bidens cernua						Laportea canadensis	X					Solidago caesia					Spirodela polyrrhiza					
Bidens frondosa						Lapsana communis						Solidago canadensis					Streptopus roseus					
Boehmeria cylindrica						Leonurus cardiaca						Solidago flexicaulis			X		Trillium erectum			X		
Callitha palustris						Lepidium						Solidago gigantea					Trillium grandiflorum			X		
Calystegia sepium						Linaria vulgaris						Solidago nemoralis					Uvularia grandiflora			X		
Cardamine diphylla						Lithospermum officinale						Solidago rugosa										
Cardamine						Lobelia						Sonchus arvensis										
Caulophyllum thalictroides	X					Lobelia inflata						Sonchus asper										
Cerastium fontanum						Lotus corniculatus						Stellaria										
Ceratophyllum demersum						Lycopus americanus	X					Tanacetum vulgare										
Chelidonium majus						Lycopus						Taraxacum officinale										
Chenopodium album						Lysimachia ciliata						Thalictrum dioicum										
Chrysanth. leucanthemum						Lythrum salicaria						Thalictrum pubescens										
Cichorium intybus						Medicago lupulina						Tiarella cordifolia			X							
Cicuta						Medicago sativum						Tragopogon pratensis										
Circaea leuteliana						Melilotus alba						Trifolium borealis										
Cirsium arvense						Mentha arvensis						Trifolium										
Cirsium vulgare						Mimulus ringens						Trifolium pratense										
Clematis virginiana						Mimulus ringens						Trifolium repens										
Clintonia borealis						Mitella diphylla						Tussilago farfara										
Coryza canadensis						Monarda fistulosa						Urtica dioica										
Coronilla varia						Myosotis						Utricularia vulgaris										
Cynanchum rossicum						Nasturtium officinale						Verbascum thapsus										
Cynoglossum officinale						Nepeta cataria						Verbena hastata										
Daucus carota						Nuphar variegatum						Verbena urticifolia										
Desmodium canadense						Nymphaea odorata						Veronica										
Dianthus armeria						Oenothera biennis						Veronica officinalis										
Dipsacus fullonum						Osmorhiza						Vicia cracca										
Echinostylis lobata						Oxalis stricta						Vicia tetrasperma										
Echium vulgare						Phytolacca leptostachya						Viola (canadensis)			X							
Epilobium						Physalis heterophylla						Viola										
Epilobium ciliatum												Viola pubescens										
Epilobium hirsutum												Viola sororia										
Epilobium parviflorum																						

SITE LOCATIONS

1: F006-c 4: _____
 2: _____ 5: _____
 3: _____ 6: _____

P7

757 GSH1006

CONIFERS						TREES and SHRUBS						GRAMINOIDS					
1	2	3	4	5	6	1	2	3	4	5	6	1	2	3	4	5	6
Abies balsamea						+ Rosa multiflora						Agrostis gigantea					
Juniperus communis						Rosa						Agrostis stolonifera					
Juniperus virginiana						Rubus allegheniensis						Agropyron repens					
Larix laricina						Rubus idaeus						Alopecurus					
Picea abies						Rubus occidentalis		X				Bromus inermis					
Picea glauca						Rubus odoratus						Calamagrostis canadensis					
Pinus resinosa						Rubus pubescens						Carex arctata					
Pinus strobus						Salix alba						Carex aurea					
Pinus sylvestris						Salix amygdaloides						Carex bebbii					
Thuja occidentalis						Salix bebbiana						Carex blanda					
Tsuga canadensis	X					+ Salix discolor						Carex gracillima					
						Salix eriocephala						Carex granularis					
						Salix exigua						Carex hystericina					
						Salix lucida						Carex pensylvanica		X			
						Salix petiolaris						Carex radiata					
						+ Salix purpurea						Carex retrorsa					
TREES and SHRUBS						Salix x rubens						Carex stipata					
Acer negundo						+ Salix						Carex stricta					
Acer rubrum						Sambucus canadensis						Carex vulpinoidea					
Acer saccharinum						Sambucus racemosa						Carex					
Acer saccharum	X					Sorbus aucuparia						Carex					
Acer spicatum						Spiraea alba						Carex					
Alnus rugosa						Syringa vulgaris						Carex					
Amelanchier						+ Tilia americana						Carex					
Berberis thunbergii						Ulmus americana		X				Carex					
Betula alleghaniensis	X					Ulmus						Carex					
Betula papyrifera						Vaccinium						Carex					
Carpinus caroliniana						Viburnum lentago						Carex					
Carya cordiformis						Viburnum opulus						Cyperus					
Celastrus scandens						Viburnum						Cyperus					
Cornus alternifolia						Vitis riparia		X				Dactylis glomerata					
Cornus amomum						Rubus canadensis		X				Danthonia spicata					
Cornus rugosa												Echinochloa crus-galli					
Cornus stolonifera	X											Eleocharis erythropoda					
Corylus cornuta												Eleocharis					
Crataegus monogyna												Elymus virginicus					
Crataegus punctata												Elymus					
Crataegus sp.												Festuca arundinacea					
Crataegus												Glyceria striata					
Diervilla lonicera												Glyceria					
Fagus grandifolia		X										Juncus dudleyi					
Fraxinus americana		X										Juncus effusus					
Fraxinus nigra		X				FERNS						Juncus tenuis					
Fraxinus pennsylvanica						Adiantum pedatum						Juncus					
Ilex verticillata						Athyrium filix-femina						Juncus					
Juglans cinerea						Botrychium multifidum						Leersia oryzoides					
Juglans nigra						Botrychium virginianum						Muhlenbergia					
Lonicera morrowi						Cystopteris bulbifera						Oryzopsis asperifolia					
Lonicera tatarica						Dryopteris carthusiana						Panicum					
Lonicera						Dryopteris cristata						Panicum'					
Malus pumila						Dryopteris marginalis						Phalaris arundinacea					
Ostrya virginiana		X				Dryopteris						Phleum pratense					
Parthenocissus inserta						Equisetum arvense						Phragmites australis					
Populus balsamifera						Equisetum hyemale						Poa compressus					
Populus grandidentata						Equisetum variegatum						Poa pratensis					
Populus tremuloides						Equisetum						Poa					
Populus						Gymnocarpium dryoperis						Scirpus atrovirens					
Prunus pensylvanica		X				Lycopodium digitatum						Scirpus cyperinus					
Prunus serotina						Lycopodium obscurum						Scirpus validus					
Prunus virginiana						Lycopodium						Scirpus					
Prunus						Lycopodium						Scirpus					
Quercus macrocarpa						Matteucia struthiopteris						Setaria					
Quercus rubra						Onoclea sensibilis		X				Sparganium					
Quercus						Osmunda cinnamonia						Typha angustifolia					
Rhamnus cathartica						Osmunda regalis						Typha latifolia					
Rhus radicans		X				Polystichum acrostichoides						Typha Xglauca					
Rhus typhina						Pteridium aquilinum											
Ribes americana						Thelypteris palustris											
Ribes cynosbati		X															
Ribes x rubrum																	
Robinia pseudo-acacia																	
Acer fremantii		X															
Lindera benzoin		X															

ELC
Community Description and Classification

Map #: 557 GSH 1006 Polygon: 2

Surveyor(s): SG, RA Date: April 25, 2001 Time start: finish: UTMZ: UTMN:

Polygon Description

System	Substrate	Topographic Feature	Plant Form	Community
<input type="checkbox"/> Terrestrial <input type="checkbox"/> Wetland <input type="checkbox"/> Aquatic <input type="checkbox"/> Site <input type="checkbox"/> Open Water <input checked="" type="checkbox"/> Shallow Water <input type="checkbox"/> Surficial Dep. <input type="checkbox"/> Bedrock <input checked="" type="checkbox"/> History <input type="checkbox"/> Natural <input type="checkbox"/> Cultural <input type="checkbox"/> Cover <input type="checkbox"/> Open <input type="checkbox"/> Shrub <input checked="" type="checkbox"/> Tree	<input type="checkbox"/> Organic <input checked="" type="checkbox"/> Mineral Soil <input type="checkbox"/> Parent Min. <input type="checkbox"/> Acidic Bedrk <input type="checkbox"/> Basic Bedrk <input type="checkbox"/> Carb. Bedrk	<input type="checkbox"/> Lacustrine <input type="checkbox"/> Riverine <input type="checkbox"/> Bottomland <input type="checkbox"/> Terrace <input type="checkbox"/> Valley Slope <input checked="" type="checkbox"/> Tableland <input type="checkbox"/> Roll Upland <input type="checkbox"/> Cliff <input type="checkbox"/> Talus <input type="checkbox"/> Crevice/Cave <input type="checkbox"/> Avar <input type="checkbox"/> Rockland <input type="checkbox"/> Beach / Bar <input type="checkbox"/> Sand Dune <input type="checkbox"/> Bluff	<input type="checkbox"/> Plankton <input type="checkbox"/> Submerged <input type="checkbox"/> Floating-LVD. <input type="checkbox"/> Graminoid <input type="checkbox"/> Forb <input type="checkbox"/> Lichen <input type="checkbox"/> Bryophyte <input checked="" type="checkbox"/> Deciduous <input type="checkbox"/> Coniferous <input type="checkbox"/> Mixed	<input type="checkbox"/> Lake <input type="checkbox"/> Pond <input type="checkbox"/> River <input type="checkbox"/> Stream <input type="checkbox"/> Marsh <input type="checkbox"/> Swamp <input type="checkbox"/> Fen <input type="checkbox"/> Bog <input type="checkbox"/> Barren <input type="checkbox"/> Meadow <input type="checkbox"/> Prairie <input type="checkbox"/> Thicket <input type="checkbox"/> Savannah <input type="checkbox"/> Woodland <input checked="" type="checkbox"/> Forest <input type="checkbox"/> Plantation

Stand Description

Layer	HT	CVR	Species in Order of Decreasing Dominance (up to 4 sp) (> Much Greater Than; > Greater Than; = About Equal To)
1	2	4	Fraxinus, Fagus
2	2	3	Fraxinus, Fagus
3	4	3	Liriodendron, Fraxinus
4	6	2	Fraxinus

HT Codes: 7 < 0.2m 6 0.2-0.5m 5 > 0.5-1m 4 > 1-2m 3 > 2-6m 2 > 6-25m 1 > 25m
 CVR Codes: 0 = none 1 0% - 10% 2 10 - 25% 3 25 - 60% 4 > 60%

Stand Composition:	Size Class Analysis:	< 10	10-24	25-50	> 50
Standing Snags:		A	R	A	A
Deadfall / Logs:		A	R	A	A

Abundance Codes: N = None R = Rare O = Occasional A = Abundant

Com. Age: Pioneer Young Mid-Age Mature Old Growth

Ecosite: Ash mixed deciduous Swamp. Code: SWD2
 Vegetation Type: green ash mixed deciduous Swamp. Code: SWD2-2
 Inclusion: Code:
 Complex: Code:

Community Profile Diagram/Comments

Notes:

Tree Tally by Species

Species	Tally 1	Tally 2	Tally 3	Tally 4	Total	Rel. Avg.
Total						100
Basal Area (BA)						
Dead						

Soils Ontario and ELC Soils Description

Site Metrics	PI/Auger #	Soils Ontario and ELC Soils Description				Summary
Zone						Moisture Regime
Easting						
Northing						
Position						Drainage
Aspect						
Percent						
Slope						Effective Texture (Indicate below)
Length						
Mottles						
Gley						% CF
Water Table						
Carbonates						
Bedrock						% CF
1						
2						
3						% CF
4						
% Surface Stone/Rock						
Moisture Regime						% CF
Drainage						

ELC
Community Description and Classification

Map #: 757-GSH 1026 Polygon: 1

Surveyor(s): S.G. RA. Date: Apr 12 2012 Time start: finish:

UTMZ: UTMZ: UTMN:

Polygon Description

System	Substrate	Topographic Feature	Plant Form	Community
<input type="checkbox"/> Terrestrial <input type="checkbox"/> Wetland <input type="checkbox"/> Aquatic <input type="checkbox"/> Open Water <input type="checkbox"/> Shallow Water <input checked="" type="checkbox"/> Surficial Dep. <input type="checkbox"/> Bedrock <input checked="" type="checkbox"/> History <input type="checkbox"/> Natural <input type="checkbox"/> Cultural <input type="checkbox"/> Cover <input type="checkbox"/> Open <input type="checkbox"/> Shrub <input checked="" type="checkbox"/> Tree	<input type="checkbox"/> Organic <input checked="" type="checkbox"/> Mineral Soil <input type="checkbox"/> Parent Min. <input type="checkbox"/> Acidic Bedrk <input type="checkbox"/> Basic Bedrk <input type="checkbox"/> Carb. Bedrk	<input type="checkbox"/> Lacustrine <input type="checkbox"/> Riverine <input type="checkbox"/> Bottomland <input type="checkbox"/> Terrace <input checked="" type="checkbox"/> Valley Slope <input checked="" type="checkbox"/> Plateau <input type="checkbox"/> Roll. Upland <input type="checkbox"/> Cliff <input type="checkbox"/> Talus <input type="checkbox"/> Crevice/Cave <input type="checkbox"/> Avar <input type="checkbox"/> Rockland <input type="checkbox"/> Beach / Bar <input type="checkbox"/> Sand Dune <input type="checkbox"/> Bluff	<input type="checkbox"/> Plankton <input type="checkbox"/> Submerged <input type="checkbox"/> Floating-LVD. <input type="checkbox"/> Graminoid <input type="checkbox"/> Forb <input type="checkbox"/> Lichen <input type="checkbox"/> Bryophyte <input checked="" type="checkbox"/> Deciduous <input type="checkbox"/> Coniferous <input type="checkbox"/> Mixed	<input type="checkbox"/> Lake <input type="checkbox"/> Pond <input type="checkbox"/> River <input type="checkbox"/> Stream <input type="checkbox"/> Marsh <input type="checkbox"/> Swamp <input type="checkbox"/> Fen <input type="checkbox"/> Bog <input type="checkbox"/> Barren <input type="checkbox"/> Meadow <input type="checkbox"/> Prairie <input type="checkbox"/> Thicket <input type="checkbox"/> Savannah <input type="checkbox"/> Woodland <input checked="" type="checkbox"/> Forest <input type="checkbox"/> Plantation

Stand Description

Layer	HT	CVR	Species In Order of Decreasing Dominance (up to 4 sp)
1	2	4	Ac. Sallow, T. Lamer
2	2	5	Ac. Sallow
3	4	3	Avyig = 1/4 beech
4	6	3	EM base = mix race

HT Codes: 7 < 0.2m 6 > 0.2-0.5m 5 > 0.5-1m 4 > 1-2m 3 > 2-6m 2 > 6-25m 1 > 25m
 CVR Codes: 0 = none 1 0% - 10% 2 10 - 25% 3 25 - 60% 4 > 60%

Stand Composition: Size Class Analysis: < 10 10-24 25-50 > 50
 Standing Snags: < 10 10-24 25-50 > 50
 Deadfall / Logs: < 10 10-24 25-50 > 50

Abundance Codes: N = None R = Rare O = Occasional A = Abundant

Com. Age: Pioneer Young Mid-Age Mature Old Growth

Ecosite: Fresh-moist sugar maple D.F. Code: F006
Vegetation Type: Fresh-moist sugar maple beech D.F. Code: F006-5
Inclusion: Code:
Complex: Code:

Community Profile Diagram/Comments

Notes:

Tree Tally by Species

Species	Tally 1	Tally 2	Tally 3	Tally 4	Total	Rel. Avg.
Total					100	
Basal Area (BA)						
Dead						

Soils Ontario and ELC Soils Description

PI/Auger #	UTM	Zone	Easting	Northing	Position	Aspect	Percent	Slope	Length	Summary
Site Metrics										
Depth to...										
Soil Horizon Description										
Mottles										
Gley										
Water Table										
Carbonates										
Bedrock										
Soil Horizon Description										
Depth from zero										
Texture										
Depth from zero										
Texture										
Depth from zero										
Texture										
Depth from zero										
Texture										
% Surface Stone/Rock										
Moisture Regime										
Drainage										

heavy salmon

green flower

Spurred m

ginger

Plant Species List 2012

Table with columns for species names and abundance counts (1-5) for three categories: Trees & Shrubs, Tree & Shrubs, and Graminoids. Includes handwritten notes and a legend at the bottom.

D - Dominant represented by large numbers, generally forming >10% ground cover or >25% vegetation cover in any one stratum
F - Fairly common (=Abundant in ELC) generally widespread represented by fairly large numbers of individual clumps, usually forming >10% ground cover
U - Uncommon (=Occasional in ELC) present as widespread scattered individuals or represented by one or more clumps of many individuals (most species will fall into this category)
R - Rare represented in the vegetation by less than about five individuals or small clump

Map Number: 364-GSH 1000 Date: April 25, 2012 Surveyors: SG, RA

Significant Wildlife Habitat Form

AECOM

Study Area:	BLW	JER	<input checked="" type="checkbox"/> GSH	Map #:	364-GSH1006
Date:	April 24, 2012			Time Started:	8:00 am
Field Staff:	SG, RA			Time Finished:	9:45 AM
Weather Conditions:	SUNNY				

Colonial Nesting Tree/Shrub Birds, Osprey Breeding/Feeding, Bald Eagle Breeding/Nesting Habitat
(FET1, FOC, FOM, FOD, SWC, SWM, SWD)

Nest bowls present: No Yes (if yes, photograph and complete the following)

UTMs: _____ Number of nests: _____

Description of nests (location, e.g. in tree/on built structure; material; evidence of recent use; birds present): _____

Description of habitat (note riparian areas if present, evidence of disturbance): _____

Waterfowls Stopover/Nesting, Amphibian Breeding, Turtle Nesting/Over-wintering, Marsh Breeding Birds
(CUM1, CUT1, MAM, MAS, SAS1, SAM1, SAF1, SWD, SWT1, SWT2) (FOC, FOM, FOD, SWC, SWM, SWD, BOO1, FEO1)

Standing water present: No Yes (if yes, photograph and complete the following)

UTMs: _____ Area of standing water delineated on field map

Water depth (m): _____ % open water: _____ % emergent vegetation: _____

Description of standing water (permanent pool, evidence of annual spring flooding, etc): _____

Area and soil/substrate of shoreline habitat: _____

Type and abundance of cover in open water habitat: _____

Type and abundance of cover in surrounding habitat: _____

Evidence of disturbance (e.g. cattle grazing): _____

Evidence of use by waterfowl, amphibians, turtles (e.g. broken eggs) marsh breeding birds:
 See Vernal pool form. No habitat for waterfowl or turtle marsh breeding birds.

*****Complete Vernal Pool Habitat Description Form*****

Snake Hibernacula

Fissured rock/foundation or rock/debris pile present: No Yes (if yes, photograph and complete the following)

UTMs: _____ Likelihood to extend below frost line: _____

% canopy cover: _____ % slope: _____ Distance to open canopy (m): _____

Description of fissure or stone pile (composition/material, dimensions, etc): _____

Description of surrounding habitat (type & abundance of cover, evidence of disturbance, etc): _____

Seeps and Springs (FOM, FOM, FOD, SWC, SWM, SWD)

Evidence of seep or spring: No Yes (if yes, photograph and complete the following)

UTMs: _____ Description (indicator species, etc): _____

NHA Site Investigation - Significant Wildlife Habitat Form

AECOM

Colonial Nesting Bird Breeding Habitat (Bank and Cliff Swallows)

(CUM1, CUT1, CUS, BLO1, BLS1, BLT1, CLO1, CLS1, CLT1)

Eroding bank, sandy hill, pits, steep slope or rock face present:

 No

 Yes (if yes, photograph and complete the following)

UTMs: _____

Location (e.g. aggregate pit, bridge): _____

Evidence of use by bank or cliff swallows (provide number of nests): _____

Colonial Nesting Ground Breeding Birds, Shorebird Migratory Stopover Areas

(BBO1, BBO2, BBS1, BBS2, BBT1, BBT2, SDO1, SDS2, SDT1, MAM1, MAM2, MAM3, MAM4, MAM5)

Shoreline of lake, large river or large wetland present:

 No

 Yes (if yes, photograph and complete the following)

UTMs: _____

Rocky island or peninsula present: _____

Mudflat present: _____

Evidence of disturbance (e.g. cattle grazing): _____

Description of habitat (size of rocky outcrop/mudflat, substrate/soil type, type and abundance of cover): _____

Raptor Winter Feeding and Roosting, Open Country or Shrub/Early Successional Bird Breeding Habitat

CUT1, CUS1, >30ha, CUM1 >30ha, FOC, FOD, FOM with a CUM, CUT, CUS, CUW > 20ha, or a CUM, CUS, CUT, CUW >15ha

Large meadow, old field or generally open habitat (e.g. CUM, CUS, CUT, CUS, CUW) present:

Large open habitat present: No

Yes (if yes, photograph and complete the following)

UTMs: _____

Evidence of disturbance (e.g. cattle grazing): _____

Description of habitat (abundance of food plants for rodents, abundance of perches, height of vegetation): _____

Old-growth or Mature Forests, Interior Forest Breeding Birds

(FOD, FOC, FOM, SWC, SWM, SWD. Mature forest (>60 years) present)

Mature forest present: No

Yes (if yes, photograph and complete the following)

UTMs: _____

Age of oldest trees: _____

Evidence of disturbance (e.g. selective cutting): _____

Description of habitat (structural complexity, abundance of snags and/or downed woody debris, etc): _____

Photo #	Location or Subject	Photo #	Location or Subject

Species of Conservation Concern Habitat and Incidental Wildlife – Goshen



ELC	Species	Habitat Description	Habitat Present (Y/N; UTM; description of habitat if present)
CUM1, MAM	June - August		
(FOD9) FOD7, FOD9	Green Dragon (<i>Ahasema dracontium</i>) - S2/S3 <u>Bloom Time - May and June</u>	Species found in damp deciduous forest and along river streams. Particularly <u>Maple forest</u> and forest dominated by Red Ash and White Elm.	Y N UTM
TPO1, TPS1, TPW1, FOM1, FOM2, FOD1, FOD2, FOD3	Hairy Bedstraw (<i>Galium pilosum</i>) - S3 <u>Bloom Time - June-August</u>	Occurs in dry, sandy woods and thickets; occasionally in dry sandy fields	Y (N) UTM:
FEO1, FES1, FET1, SWC, SWM, SWD, SWT, TPO, TPS, TPW	Hairy Valerian (<i>Valeriana edulis</i>) - S1 <u>Bloom Time - June to August</u>	Inhabits swampy river flats and meadows, wet prairies, and wooded, rocky riverbanks and fens.	Y (N) UTM:
(FOD6) FOD7, SWM, SWD	Hairy Wood Mint (<i>Blephilia hirsuta</i>) - S1 <u>Bloom Time - Summer</u>	<u>Woodlands</u> , often rocky, especially rivers. Rich woods, swamp forests, floodplains	Y N UTM
FOD6, FOD7, FOD8, FOD9	Harbinger-of-spring (<i>Engenia bulbosa</i>) - S3 <u>Bloom Time - early to late April</u>	Occurs in rich, moist deciduous woods, especially on floodplains.	Y N UTM
SAS1, SAM1, SAF1	Hill's Pond Weed (<i>Potamogeton hillii</i>) - SC/IS2 <u>Bloom Time - summer</u>	Aquatic plant found in highly alkaline waters of ditches, ponds, beaver ponds, and slow-moving cold waters.	Y (N) UTM
FOM6, FOM7, FOM8	Large Round-leaved Orchid (<i>Platanthera macrophylla</i>) - S2 <u>Bloom Time - June to August</u>	Species inhabits moist mixed woods. Found in fairly mature, upland sugar maple-beech-eastern hemlock woodlands.	Y (N) UTM
MAM2, MAM3, MAS2, MAS3, SWD	Lizard's Tail (<i>Saururus cernuus</i>) - S3 <u>Bloom Time - June - September</u>	Species inhabits shores and streambanks along shallow water. As well as swamps floodplains, shallow water and mudflats at the borders of streams and ponds	Y (N) UTM:
(FOD6) FOD7, FOD9	Pawpaw (<i>Asimina triloba</i>) - S3 <u>Bloom Time - March-May</u>	Occurs in moist, deciduous woods and stream banks.	Y N UTM:
FOM8, FOD6, FOD7, FOD8, CUM1	Pilose Evening Primrose (<i>Oenothera pilosella</i>) - S2 <u>Bloom Time - Late Spring - Early Summer</u>	Moist edges of woods and open, disturbed ground	Y (N) UTM
TPW1, FOM1, FOM2, FOD1, FOD2, FOD3	Prostrate Tick-trefoil (<i>Desmodium rotundifolium</i>) - S2 <u>Bloom Time - July-September</u>	Dry, sandy or rocky woods	Y (N) UTM
FOD7, SWD	Pumpkin Ash (<i>Fraxinus profunda</i>) - S2? <u>Bloom Time - March - June</u>	Swamps and floodplains	Y (N) UTM
CUM1, ALO, FET1, SWC	Ram's-head Lady's-slipper (<i>Cypripedium arietinum</i>) - S3 <u>Bloom Time - mid May to mid June</u>	Found in cedar woodlands, limestone plains and wooded fens, moist coniferous swamps, dry-sandy woods, and limestone barren.	Y (N) UTM:
FOD1, FOD2, FOD3, FOD4, FOD5, FOC1, FOM1, FOM5	Rattlesnake Hawkweed (<i>Hieracium venosum</i>) - S2 <u>Bloom Time - April - September</u>	Species inhabits open, dry sandy woods, Jack pine, oak, and aspen woodlands.	Y (N) UTM
(FOD6) FOD7, FOD9	Round-leaved Grubweed (<i>Packera obovata</i>) - S3 <u>Bloom Time - May - June</u>	Found in moist woods	Y N UTM
CUM1, CUT1, CUS1	Round-leaved Hawthorn (<i>Crataegus lumarina</i>) - S3?	Species occurs in old fields, poorly managed pastures, fencelines and roadsides	Y (N) UTM
(FOD6) FOD7, FOD8, FOD9, SWT2, SWT3	Scarlet Beebalm (<i>Monarda didyma</i>) - S3 <u>Bloom Time - May to October</u>	Found in moist, rich woods, thicket swamps, banks and floodplains	Y N UTM:
ALO, ALS, ALT, TPO, TPS, TPW	Slender Blazing Star (<i>Liatris cylindracea</i>) - S3	Species occurs in limestone and dolostone pavement, prairies, open woods, always and moist sandy meadows	Y (N) UTM:
SBO, SBS, SBT, TPO1, TPS1, TPW1, FOD1, FOD2	Slender Knotweed (<i>Polygonum tenue</i>) - S2	Found in dry, sandy, open areas in deciduous (often oak woods), prairie meadows at edges of sand pits	Y (N) UTM:
SDT1, FOD5, FOD9	Slim-flowered Muihly (<i>Muhlenbergia tenuiflora</i>) - S2	Found in rich deciduous forest, often on rocky or sandy soils, wooded dunes, hillsides, and riverbanks whether in oak or beech-maple woods	Y (N) UTM:
BLO1, BLS1, BLT1, TPO2, TPS2, TPW2, MAM2, FOD7	Stiff Gentian (<i>Gentiana quinquefolia</i>) - S2 <u>Bloom Time - late summer to mid fall</u>	Found in moist soils of streambanks, edges of woods, wet prairies, marshy meadows, bluffs and wooded hillsides.	Y (N) UTM:
TPS1, TPW1, CUW1, RBO, SBO	Sundial Lupine (<i>Lupinus perennis</i>) - S3 <u>Bloom Time - mid-March to mid-June</u>	Inhabits dry, sandy oak savannas, prairies, open barrens or clearings in woodlands of oak, jack pine, and/or aspen.	Y (N) UTM

Species Conservation Concern Habitat and Incidental Wildlife - Goshen



Map No: 364-GSH1006
Date (yyyy-mm-dd): 2012-04-25

Field Staff: BA, SG

Time Started: 8:00am
Time Finished: 9:45am

Observed Species List

Species Code	UTM	EV	Notes	Species Code	UTM	EV	Notes
Blue Jay		VO					
Black Legged Kittiwake		VO					
Horned Lark		VO					
Song Sparrow		VO					
Brewer's Thrasher		VO					
White Breasted Nuthatch		VO					
Vesper Sparrow		VO					
Brown Headed Cowbird		VO					
Red Bellied Woodpecker		OB					
Northern Flicker		VO					
Hairy Woodpecker		VO					
Yellow Duck		OB	Fly Over				
AMERICAN Goldfinch		VO					
Wild Turkey		OB					

Note: Evidence Codes (EV)

Breeding Bird (Possible) SH=Suitable Habitat, SM=Singing Male;

Breeding Bird (Probable) T-Territory, D=Display, P=Pair, N=Nest Building, V= Visiting Nest; A=Anxiety Behavior;

Breeding Bird (Confirmed) DD=Distracted, NU=Used Nest, FY=Fledged Young, NE=Eggs, NY=Young, FS=Foos/Faecal sack, AE=Nest Entry

Other Wildlife Evidence: OB=observed, VO=observed, CA=Carass, DP=Distinctive Parts, HO=House/Den, FY=Eggs/young, TK=tracks, FE=Feeding evidence, SC= Scat, SI=Other signs (specify)

ELC	Species	Habitat Description	Habitat Present (Y/N); UTM; description of habitat if present
PLANTS			
FOD7	American Groundwell (Lithospermum latifolium) - S3 Bloom Time - Spring	Shaded river banks, wooded floodplains. River floodplains, woods and edges of woods.	Y (N) UTM
ALO, TPO	Muehlenberg's astomum moss (Astomum muehlenbergianum) - S2 Bloom Time - Spring	Thin soil over level outcrop ledges and on soil under grasses in open prairie	Y (N) UTM
FOM1, FOM2, CUP3	Autumn Coral-root (Coralorhiza odontorhiza) - S2 Bloom Time - summer to fall	Oak-pine woods or occasionally in open, red pine or white pine plantations. Dry, sandy woods	Y (N) UTM
FOC, FOM (FOB)	Burning Bush (Euonymus atropurpureus) - S3 Bloom Time - April - June	Species occurs in dry to moist deciduous thickets and woods	Y (N) UTM
SWC1, SWC3, SWC4, SWM1, SWM2, SWM4, SWM5, SWM6	Chinese Hemlock Parsley (Conioselinum chinense) - S2 Bloom Time - summer to fall	Swampy places with deciduous trees, white cedars, tamarack, springy river banks, wet borders of streams and rivers. Also found among calcareous seepage slopes.	Y (N) UTM
SWC, SWM, SWD, SWT, MAM, MAS	Crowned Beggarticks (Bidens trichosperma) - S2 Bloom Time - late summer	Found in openings in swamps, marshes, along shores & wet fields within the Carolin an zone and southeastern Georgian bay. Bogs, fens, tamarack swamps.	Y (N) UTM
ALT1, FOD7	Eastern Green-violet (Hybanthus concolor) - S2 Bloom Time - mid March to August	Occurs in rich, wet-mesic floodplain forests as well as mesic forests over limestone. Includes floodplains and river banks.	Y (N) UTM
TPS, TPW, FOM1, FOM2	Fogg's Goosefoot (Chenopodium foggii) - S2	Species occurs in sandy areas on limestone under oak or pine-oak forests	Y (N) UTM
TPO2, TPS2, TPW2	Giant Ironweed (Vernonia gigantea) - S1? Bloom Time -	Found in mesic prairies, thickets, moist woods, roadsides and grassy meadows	Y (N) UTM

Species Conservation Concern Habitat and Incidental Wildlife – Goshen



ELC	Species	Habitat Description	Habitat Present (Y/N): UTM: description of habitat if present
TP01, TPS1, TPW1, CUM1	Tail Blazing Star (<i>Liatris aspera</i>) - S2/SC	Occurs in open, sandy woods, dry roadsides and sandy prairies	Y (N) UTM: NO
MAM3	Tuberous Indian Plantain (<i>Arnoglossum plantagineum</i>) - S3 S3 Bloom Time – mid-March to mid-June	Occurs mainly in flat, sandy areas of the Bruce Peninsula. Fens, wet meadows, and alluvial river flats.	Y (N) UTM: NO
FOC1, FOC2, FOC3, FOC4	Woodland Pinedrops (<i>Pterospora andromedea</i>) - S2 Bloom Time – summer	Found in conifer woods, under pines, but also hemlock, spruce, fir, and white cedar in dry or rocky soil, often with common juniper and sometimes aspen or birch	Y (N) UTM: NO
CUM1, CUT1, CUW1, RBO1, SBO1	Yellow Ladies'-tresses (<i>Spiranthes ochroleuca</i>) - S2 Bloom Time – August to November	Dry, open sites, usually on acidic sandy soil, dry to mesic open woodland thickets, meadows, barrens, ledges, outcrops, banks and roadsides, old fields.	Y (N) UTM: NO
BIRDS			
-	Bald Eagle (<i>Haliaeetus leucocephalus</i>) - SC	Assessed as SWH. Record species if found.	not required.
CUW, SDO, RBO, TPS	Common Nighthawk (<i>Chordeiles minor</i>) - SC	Hunts insects over a wide variety of habitats, in particular open or semi-open areas. Nests on ground in a wide range of open, rocky or vegetation-free habitats.	Y (N) UTM: NO
FOD, FOM	Louisiana Waterthrush (<i>Seiurus motacilla</i>) - SC	Inhabits mature forests along steeply sloped ravines adjacent to running water. Trees, bushes, exposed roots, cliffs, banks and mossy logs are favoured nesting spots. Riparian woodlands are preferred stopover sites during migration	Y (N) UTM: NO
FOD, CUW, CUT	Red-headed Woodpecker (<i>Meianerpes erythrocephalus</i>) - SC	Species inhabits open woodland/edges (oak savannahs and riparian forest), open, deciduous forest with little understory, fields or pasture lands with scattered large trees; wooded swamps; orchards, small woodlots or forest edges; groves of dead or dying trees; requires cavity trees with at least 40 cm dbh; requires about 4 ha for a territory.	Y (N) UTM: NO
-	Short Eared Owl (<i>Asio flammeus</i>) - SC	Assessed as SWH. Record species if found.	not required.
CUT1	Yellow-breasted Chat (<i>Icteria virens</i>) - SC	Inhabits thickets, tall tangles of shrubbery beside streams, ponds, overgrown bushy clearings with deciduous thickets, nests above ground in bush, vines	Y (N) UTM: NO
REPTILES			
-	Eastern Ribbonsnake (<i>Thamnophis sauritus</i>) - SC	Assessed as SWH. Record species if found.	not required.
-	Milksnake (<i>Lampropeltis triangulum</i>) - SC	Assessed as SWH. Record species if found	not required.
-	Snapping Turtle (<i>Chelydra serpentina</i>) - SC	Assessed as SWH. Record species if found.	not required.
INSECTS			
OAO, SA, SWM, SWD	Azure Bluet (<i>Eriallagma aspersum</i>) - S3	Species inhabits fishless ponds, lakes and boggy swamps	Y (N) UTM: NO
TPS, TPW	Sleepy Duskywing (<i>Erynnis brizo</i>) - S1	Occurs in oak/oak-pine scrub, chaparral, barrens, well-drained sandy or shaly soils	Y (N) UTM: NO
CUM1, CUT1, CUW1	Monarch Butterfly (<i>Danaus plexippus</i>) - SC	Species regularly seen at flowers in oak woods, on the ground, and at mud puddles. Their larvae only feed on milkweeds (<i>Asclepius</i> spp.). Habitat includes abandoned farmland, along roadsides, open spaces where these plants grow	Y (N) UTM: NO
TPS, CUW	Mottled Duskywing (<i>Erynnis martialis</i>) - S2	Usually seen nectaring or on wet sandy roads. Larvae feeds on New Jersey Tea and adults only likely near where this plant is present	Y (N) UTM: NO
SWT, SWD, SWM, FOM, FOD4-3, TPW, TPS, CUM1	Tawny Emperor (<i>Asterocampa clyton</i>) - S3	Species inhabits densely wooded riparian areas, dry woods, open woods, fence-rows and parks. Usually occurs near Hackberry, the larval foodplant	Y (N) UTM: NO
FOD5	West Virginia White (<i>Pieris virginianensis</i>) - SC	This species is restricted to rich, moist, deciduous woods, where its foodplant, foxtailwort occur	Y (N) UTM: NO

Goshen ELC DEJ6/SMN15

321-GSH 2100
759-GSH 2100

Goshen

July 20/11

Temp 27°C
Wind: B:0 (hazy)
Cloud 50%
Phase: III

dry Pond (0.10)

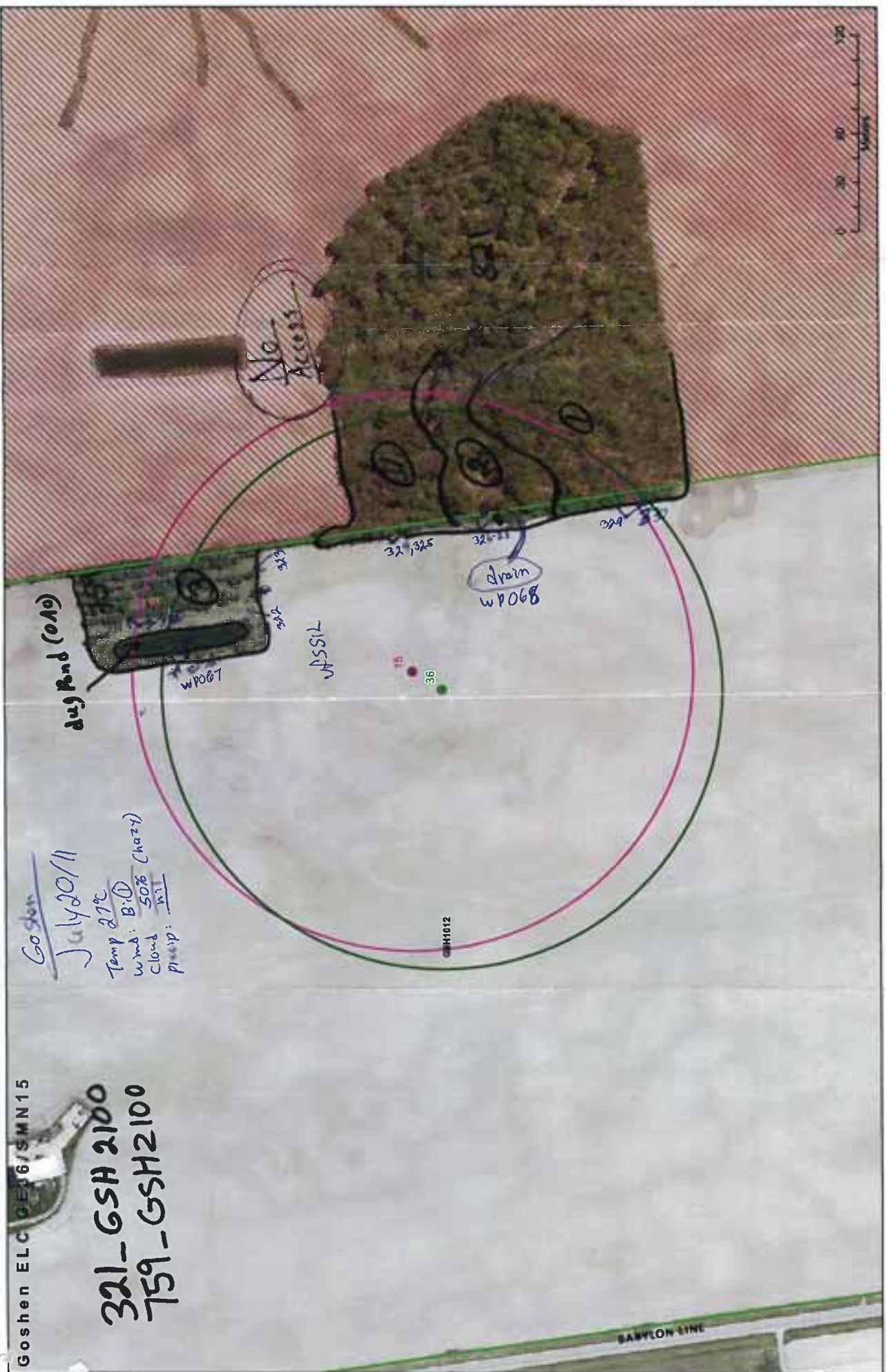

759 GSH 2/00/10/12

ELC Community Description and Classification

Site: Cohan GE365AM15 Polygon: 3

Surveyor: AM Date: July 20/11 Time start: 0938h finish: 1026h

UTMZ: 17T UTMZ: UTMN:

Polygon Description WP 067

System	Substrate	Topographic Feature	Plant Form	Community
<input checked="" type="checkbox"/> Terrestrial <input type="checkbox"/> Wetland <input type="checkbox"/> Aquatic <input type="checkbox"/> Open Water <input type="checkbox"/> Shallow Water <input type="checkbox"/> Surficial Dep. <input type="checkbox"/> Bedrock <input type="checkbox"/> Natural <input checked="" type="checkbox"/> Cultural <input type="checkbox"/> Cover <input type="checkbox"/> Open <input type="checkbox"/> Shrub <input checked="" type="checkbox"/> Tree	<input type="checkbox"/> Organic <input checked="" type="checkbox"/> Mineral Soil <input type="checkbox"/> Parent Mln. <input type="checkbox"/> Acidic Bedrk <input type="checkbox"/> Basic Bedrk <input type="checkbox"/> Carb. Bedrk	<input type="checkbox"/> Lacustrine <input type="checkbox"/> Riverine <input type="checkbox"/> Bottomland <input type="checkbox"/> Terrace <input type="checkbox"/> Valley Slope <input checked="" type="checkbox"/> Tableland <input type="checkbox"/> Roll. Upland <input type="checkbox"/> Cliff <input type="checkbox"/> Talus <input type="checkbox"/> Crevice/Cave <input type="checkbox"/> Aivalr <input type="checkbox"/> Rockland <input type="checkbox"/> Beach / Bar <input type="checkbox"/> Sand Dune <input type="checkbox"/> Bluff	<input type="checkbox"/> Plankton <input type="checkbox"/> Submerged <input type="checkbox"/> Floating-LVD. <input type="checkbox"/> Graminoid <input type="checkbox"/> Forb <input type="checkbox"/> Lichen <input type="checkbox"/> Bryophyte <input type="checkbox"/> Deciduous <input type="checkbox"/> Coniferous <input checked="" type="checkbox"/> Mixed	<input type="checkbox"/> Lake <input type="checkbox"/> Pond <input type="checkbox"/> River <input type="checkbox"/> Stream <input type="checkbox"/> Marsh <input type="checkbox"/> Swamp <input type="checkbox"/> Fen <input type="checkbox"/> Bog <input type="checkbox"/> Barren <input type="checkbox"/> Meadow <input type="checkbox"/> Prairie <input type="checkbox"/> Thicket <input type="checkbox"/> Savannah <input type="checkbox"/> Woodland <input type="checkbox"/> Forest <input checked="" type="checkbox"/> Plantation

Stand Description

Layer	HT	CVR	Species In Order of Decreasing Dominance (up to 4 sp)
1			<u>Red Pine > White Pine > Austrian Pine > White Spruce > Blue Spruce</u>
2			<u>White Ash > R.55 Willow = Saw X K.14 Beech</u>
3			<u>Smooth Brome = Orchard Grass > Astericeae > Red Pine</u>
4			<u>Birds-foot Trefoil > Self Heal > Red Clover</u>

HT Codes: 7 < 0.2m 8 > 0.2-0.5m 9 > 0.5-1m 4 > 1-2m 3 > 2-5m 2 > 5-25m 1 > 25m
 CVR Codes: 0 = none 1 0% - 10% 2 10 - 25% 3 25 - 50% 4 > 50%

Stand Composition: Size Class Analysis:

Standing Snags:	<10	10-24	25-50	>50
Deadfall / Logs:	<10	10-24	25-50	>50

BA: N/A

Abundance Codes: N = None R = Rare O = Occasional A = Abundant

Com. Age: Pioneer Young Mid-Age Mature Old Growth

Ecosite: Red Pine Coniferous Plantation Code: CUP3-1

Vegetation Type: Open Aquatic (Aug Pond) Code: OAO

Inclusion: Code:

Complex: Code:

Community Profile Diagram/Comments

Notes:

Tree Tally by Species

Species	Tally 1	Tally 2	Tally 3	Tally 4	Total	Prin. Factor
<u>N/A</u>						<u>2</u>
Total					<u>100</u>	
Basal Area (BA)						
Dead						

Soils Ontario and ELC Soils Description

Site Metrics		Pit/Auger #	Soils Ontario and ELC Soils Description				Summary
Zone	Easting						Moisture Regime
Northing	Position						
Aspect	Percent						Drainage
Slope	Length						
Mottles							Effective Texture (Indicate below)
Gley	Water Table						
Carbonates	Bedrock						% CF
1	Depth from zero						
Texture	2						% CF
3	Depth from zero						
Texture	4						% CF
4	Depth from zero						
Texture	% Surface Stone/Rock						Moisture Regime
Moisture Regime	Drainage						

ELC WILDLIFE	SITE: GE26/SHN15
	POLYGON: 1-3
	DATE: July 30/11
	SURVEYORS: SAM
	START TIME: 0938 END TIME: 1026

TEMP (°C): 23	CLOUD (10th): 2	WIND: 1-2	PRECIPITATION: nil
CONDITIONS:			

POTENTIAL WILDLIFE HABITAT:

<input type="checkbox"/>	VERNAL POOLS	<input type="checkbox"/>	SNAGS
<input type="checkbox"/>	HIBERNACULA	<input type="checkbox"/>	FALLEN LOGS
<input type="checkbox"/>		<input type="checkbox"/>	

SPECIES LIST:

TY	SP. CODE	EV	NOTES	#	TY	SP. CODE	EV	NOTES	#
B	SOSP	OB							
B	DWBL	VO							
B	AMRO	OB							
B	CHSP	OB							
B	AMCR	VO							
B	BCCA	OB							
B	COGR	OB							
B	BARS	VO							
B	AMGO	VO							
M	Wt Deer	TK							

FAUNAL TYPE CODES (TY):

B = BIRD M = MAMMAL H = HERPETOFAUNA L = LEPIDOPTERA F = FISH O = OTHER

EVIDENCE CODES (EV):

BREEDING BIRD - POSSIBLE:

SH = SUITABLE HABITAT SM = SINGING MALE

BREEDING BIRD - PROBABLE:

T = TERRITORY D = DISPLAY P = PAIR
A = ANXIETY BEHAVIOUR N = NEST BUILDING V = VISITING NEST

BREEDING BIRD - CONFIRMED:

DD = DISTRACTION NU = USED NEST FY = FLEDGED YOUNG
NE = EGGS NY = YOUNG FS = FOOD/FECAL SACK
AE = NEST ENTRY

OTHER WILDLIFE EVIDENCE:

OB = OBSERVED VO = VOCALIZATION CA = CARCASS
DP = DISTINCTIVE PARTS HO = HOUSE/DEN FY = EGGS/YOUNG
TK = TRACKS FE = FEEDING EVIDENCE SC = SCAT
SI = OTHER SIGNS (specify)