

W14

17T 4893946 / 0526017

CULVERT DRY NO FLOW

NO STANDING WATER

PHOTOS TAKEN

W20

17T 4894069

0526029

NORTH SIDE

WILLOW/CATTAIL RIPARIAN

NO FLOW

CULVERT ON N SIDE

BARRIER TO FISH MOVEMENT

ROADKILL MINK FOOT  
PORCUPINE

LKR

W20

TEMP 18°C

SOUTH SIDE

MINOR FLOW &lt; 30cm WIDE

DEPTH

- OILY SHEEN

RIPARIAN - MARSH CATTAIL / PASTURE

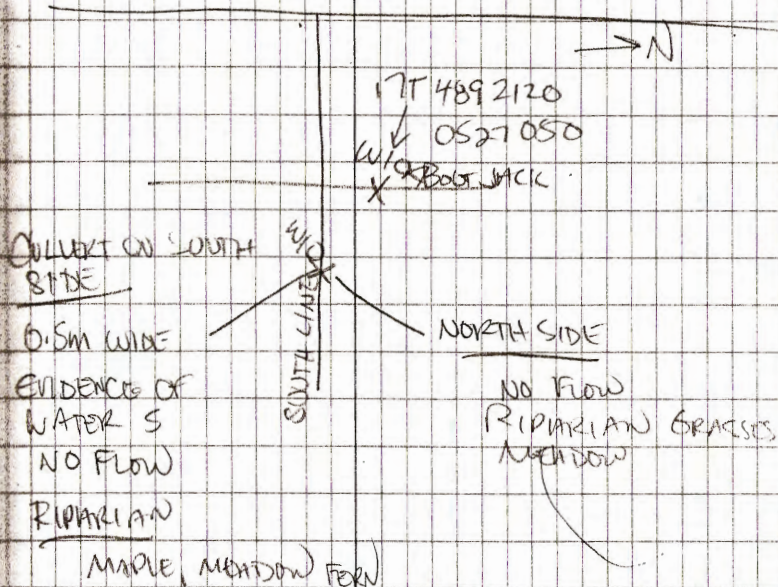

AUG 1, 2012

4 OF 4

W6 WEST OF ROAD TO T13

NO FLOW

NO WATER

25CM CULVERT

GRASSES SUGGEST THAT

CHANNEL IS DRY A

LARGE MAJORITY OF THE TIME

(LIKELY SPRING DRAINAGE)

→ GARTERSNAKE ROAD IN  
SOUTH LINEPOND D - from roadside - no temp  
no access

177 4898087

0525679

← check from  
last notes

POND VERY LOW

WATER STAGNANT - ALGAE

+ LILY COVERED

POND B

24°C WATER TEMP

BASKING TURTLE - PAINTED

GREEN FROG

4-5cm in size

WATER BROWNISH

CLEAR

SURFACE 90% LILY PADS