

Note:  
 \* The Wire Frame Technical drawing does not take into consideration vegetation. It is possible that wind turbines are visible on the wire frame drawing but not on the visual simulation.

## TECHNICAL DATA

### PHOTOGRAPH - VIEW POINT

Photograph Number: 42  
 Coordinates (UTM 17 NAD83): 439255 E 4756180 N  
 Altitude with respect to mean sea level: 234 m  
 Date Photograph was taken: November 3<sup>rd</sup>, 2011  
 Direction: 330 degrees T.N.  
 Focal Length: 28 mm  
 View span: 65 degrees  
 Altitude of photograph with respect to ground: 1.8 m

### WIND TURBINES USED

Model: GE 1.6 100  
 Height of nacelle—mid point: 80 m  
 Rotor Diameter: 100 m

### SIMULATION

Visual Simulation No.: PM03-1009ADE-42-E439255\_N4756180-L01-T02-D330-MLR01.WFV  
 Configuration No.: L01-1009ADEL-PHOM-20111102-AN.WFL  
 Total number of wind turbines for the project: 38  
 Total number of visible wind turbines in visual simulation: 11  
 Closest visible wind turbine: No 30 at 2.0 km  
 Furthest visible wind turbine: No 13 at 4.2 km

## MAP

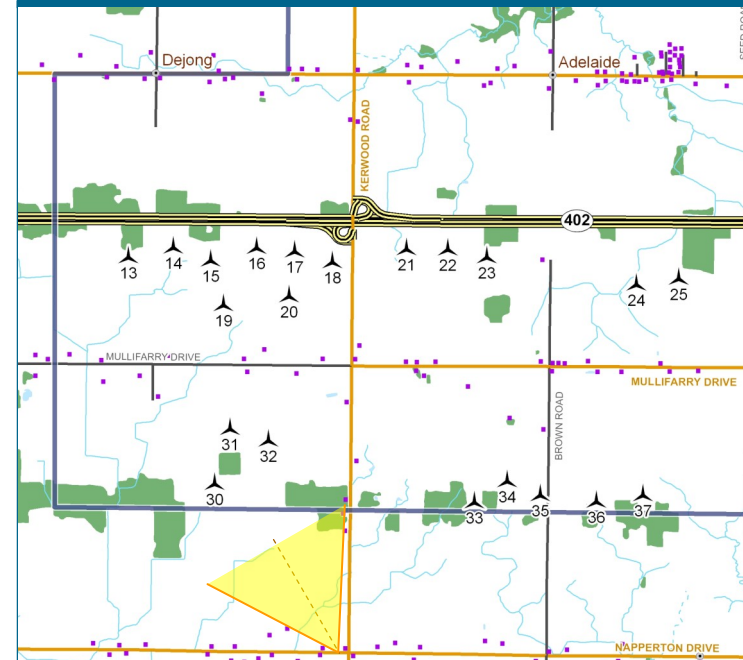

Prepared for:



Prepared by:



GL Garrad Hassan  
 Date: April 19<sup>th</sup>, 2012  
 Version 01

## VISUAL SIMULATION

As viewed from the intersection of  
 Kerwood Road and Napperton Drive

*Adelaide Wind Farm*