

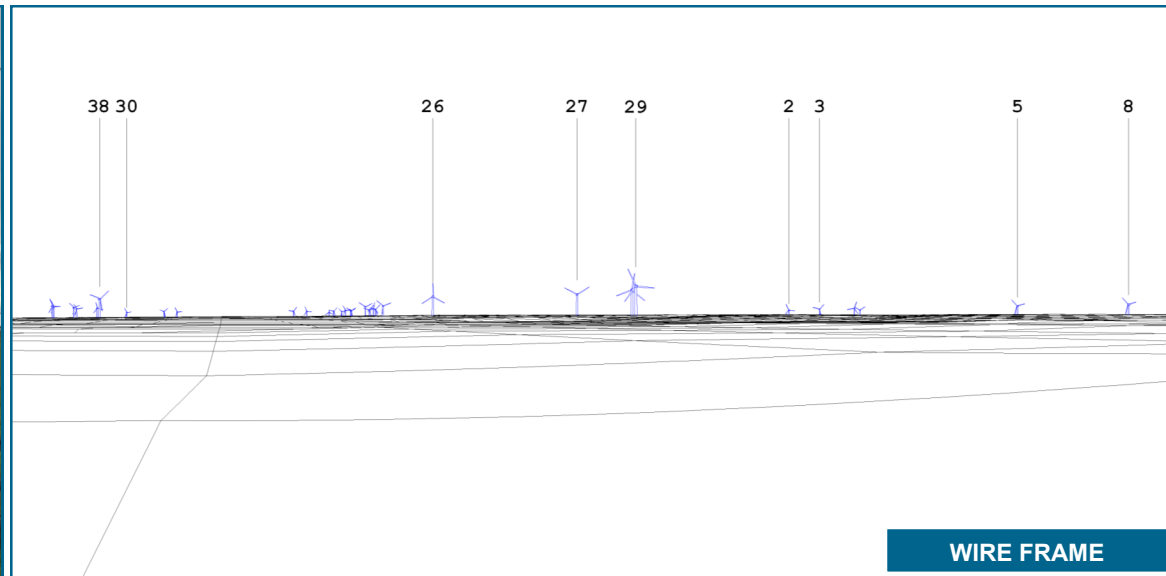

VISUAL SIMULATION



ORIGINAL PHOTO



WIRE FRAME

Note:
 * The Wire Frame Technical drawing does not take into consideration vegetation. It is possible that wind turbines are visible on the wire frame drawing but not on the visual simulation.

TECHNICAL DATA

PHOTOGRAPH - VIEW POINT

Photograph Number:	43
Coordinates (UTM 17 NAD83):	448567 E 4758701 N
Altitude with respect to mean sea level:	241 m
Date Photograph was taken:	November 3 rd , 2011
Direction:	290 degrees T.N.
Focal Length:	28 mm
View span:	65 degrees
Altitude of photograph with respect to ground:	1.8 m

WIND TURBINES USED

Model:	GE 1.6 100
Height of nacelle—mid point:	80 m
Rotor Diameter:	100 m

SIMULATION

Visual Simulation No.:	PM04-1009ADE-43-E448567_N4758701-L01-T02-D290-MLR01.WFV
Configuration No.:	L01-1009ADEL-PHOM-20111102-AN.WFL
Total number of wind turbines for the project:	38
Total number of visible wind turbines in visual simulation:	8
Closest visible wind turbine:	No 29 at 2.8 km
Furthest visible wind turbine:	No 2 at 8.1 km

MAP

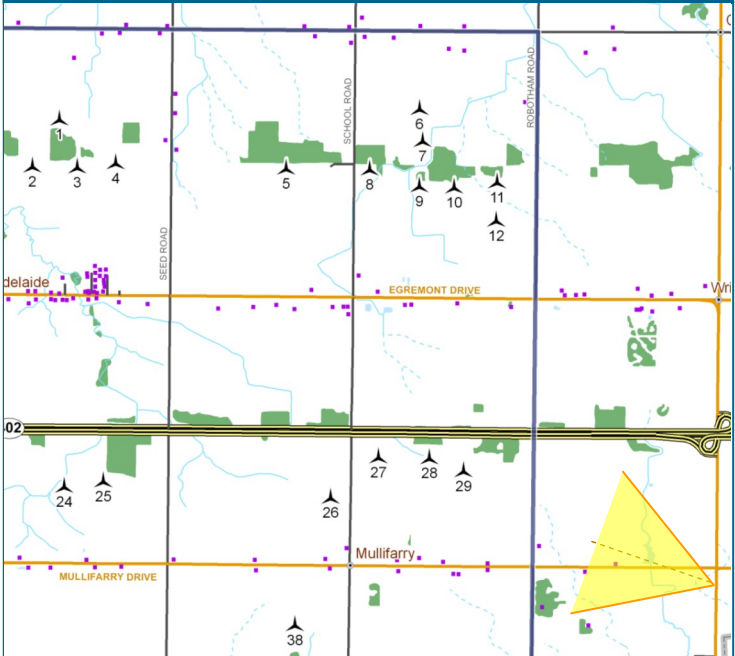

Prepared for :



Prepared by :



GL Garrad Hassan
 Date : April 19th, 2012
 Version 01

VISUAL SIMULATION

As viewed from 100 m south of the intersection of Centre Road and Mullifarry Drive

Adelaide Wind Farm